

Provided Parts



Bolt x4



Allen Wrench x1

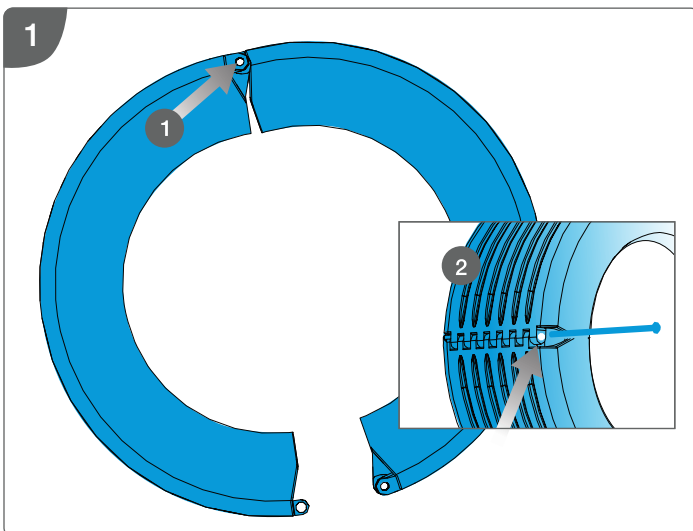
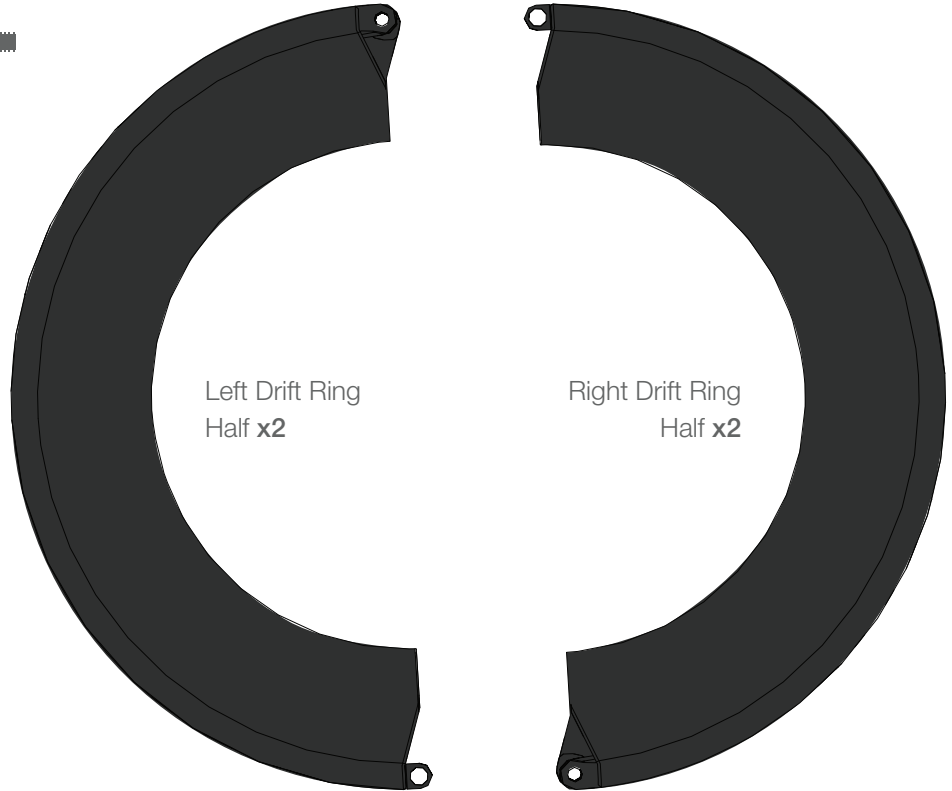

Interlock left Drift Ring Half with the right Drift Ring Half (1). Insert **one** bolt through the interlocked Drift Ring (2).

Use Allen Wrench to tighten bolt until the bolt head is firmly against the Drift Ring. **Do not overtighten.**



Bolt x4

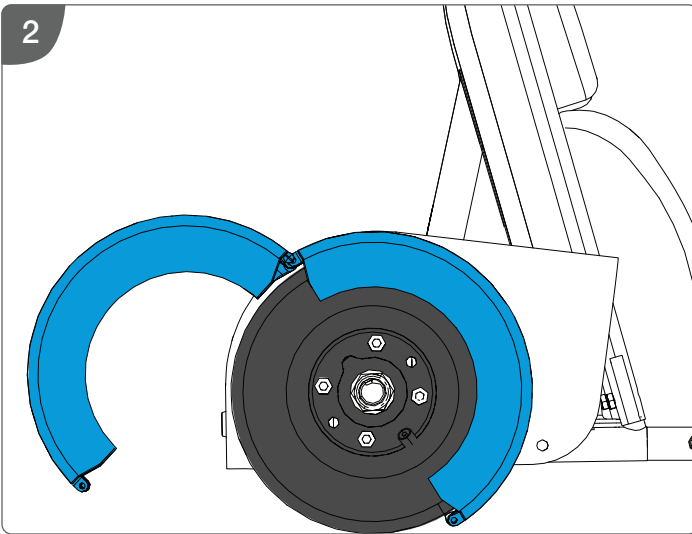

Open the Drift Ring wide and place one half of the Drift Ring over the rear tire.

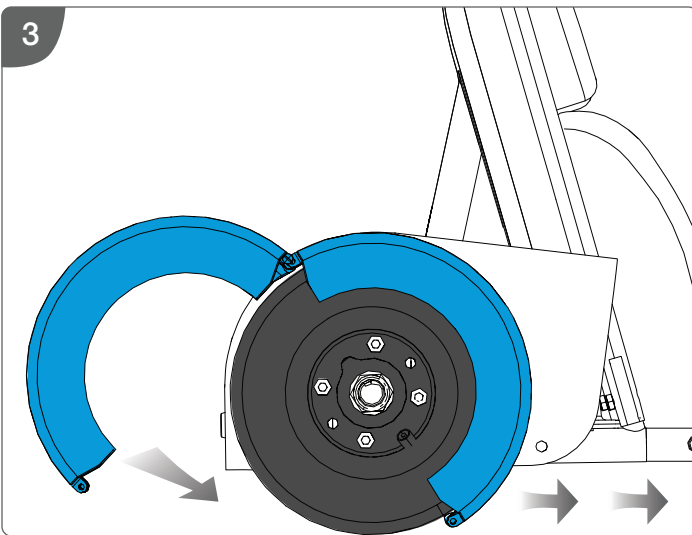

Push the Arrow forward while holding the Drift Ring onto the tire.

Guide the rest of the Drift Ring onto the tire as the Arrow rolls forward.

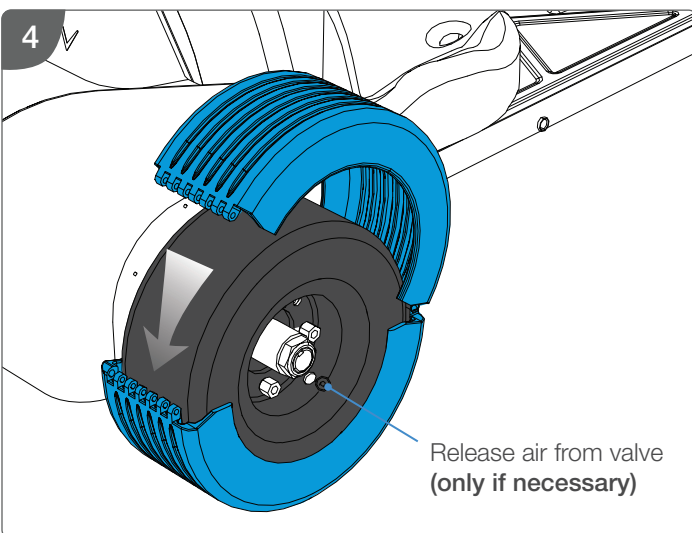

Press the two halves together to interlock.

If they do **not** interlock, release a **very** small amount of air from the tire and try again.

Note: When you remove Drift Rings you may need to add air into the tires. We recommend 18 psi. Do not exceed 50 psi.

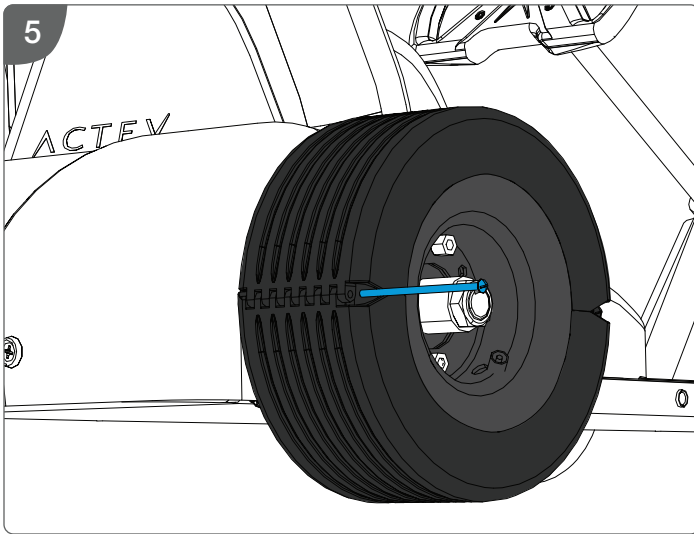

Insert the second bolt through the interlocked Drift Ring and tighten as explained in Step 1.

Repeat Steps 1-5 for the opposite Drift Ring.

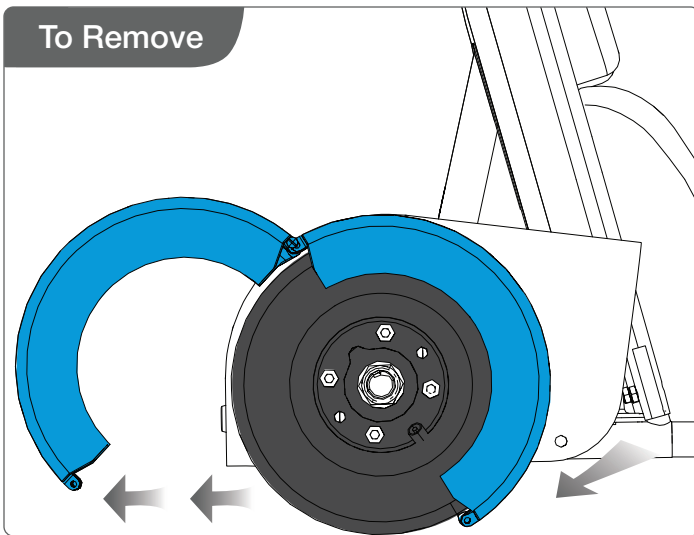

Loosen and remove one of the bolts.

Push the Arrow backwards and guide the Drift Ring off.

IMPORTANT WARNINGS

The information in this document affects safety and your legal rights and responsibilities. Failure to carefully read and follow the assembly instructions and warnings may result in serious injury to you, your child or bystanders, and result in damage to your Drift Rings.

Failure to assemble and install the Drift Rings correctly and use this product in a safe and responsible manner could result in injury or damage to the product, or other property.

By using the Drift Rings you hereby agree to this disclaimer and signify that you have read it fully. Actev Motors assumes no liability for damages or injuries incurred directly or indirectly from misuse of this product. Misuse includes, but is not limited to, using unapproved hardware, altering the Drift Rings, failing to properly install Drift Rings and using product without adult supervision.

The Drift Rings is to be used with the Arrow Smart-Kart only.

LIMITED WARRANTY

Actev Motors provides a 120-day limited warranty from the delivery date of your Drift Rings.

This warranty covers normal use but does not cover the product if damaged by improper use, neglect, accident, abuse, misuse, improper service or other causes not arising out of defects in materials or workmanship. Improper use includes driving on unpaved surfaces, on hills or in wet conditions. Evidence of any attempt at consumer repair will void this warranty.

THIS WARRANTY DOES NOT COVER, AND IS INTENDED TO EXCLUDE, ANY LIABILITY ON THE PART OF ACTEV MOTORS, WHETHER UNDER THIS WARRANTY OR IMPLIED BY LAW FOR ANY INDIRECT OR CONSEQUENTIAL DAMAGES FOR BREACH OF WARRANTY. SOME STATES DO NOT ALLOW THE EXCLUSION OR LIMITATION SO THIS LIMITATION MAY NOT APPLY TO YOU.

If this product has a manufacturing defect within 120 days of receipt, contact warranty@actevmotors.com. Please keep your shipping box. The warranty does not cover return shipping damage resulting from insufficient packaging.

DRIFT RINGS WARNINGS

- Follow all assembly and installation instructions.
- Use supplied hardware and tools to assemble and install Drift Rings.
- Only use Drift Rings with Arrow Smart-Kart.
- The Drift Rings should only be placed on the rear tires.
- Both Drift Rings must be used.
- **Warning: using Drift Rings reduces traction for accelerating, turning and braking.**
- Drift Rings should only be used on flat paved surfaces.
- Warning: When using Drift Rings, the Arrow's brakes will not work as well and will not stop the Arrow as quickly.
- Only experienced drivers should use Drift Rings.
- You may need to let out a little air for Drift Rings to fit over the tires. When removing Drift Rings make sure tire pressure is between 18 and 30 psi.
- **Caution: Plastic Drift Rings will wear down and thin. Make sure you frequently check Drift Rings. Replace Drift Rings when plastic becomes paper thin or develops a hole.**

Drift Rings are a trademark of Actev Motors, Inc. Names of products, brands, etc., appearing in this manual are trademarks or registered trademarks of their respective owner companies. This manual is copyrighted by Actev Motors, Inc. with all rights reserved. No part of this product or document shall be reproduced in any form without the prior written consent or authorization of Actev Motors, Inc.



WARNING

CHOKING HAZARD —

**This product contains small parts.
Not for children under 3 years old.**



WARNING

To reduce the risk of injury, adult supervision is required. Never use in roadways, near motor vehicles, on or near steep inclines or steps, swimming pools or other bodies of water; always wear shoes, and never allow more than one rider.



WARNING

This product to be assembled by an adult.

Recommended Age: 5-9 years old

Weight Limit: 130lbs (59kg)